

# Differential Pressure Gauge

Model No. **SS-3302 Series**

**DAEJIN**



**SS-3302**

[The utility model registration] 20-0435022

## Summary

This gauge has L (low pressure side) and H (high pressure side) in pressure access port. By indicating the differential of pressure (differential pressure) of 2 places, it is able to measure the differential pressure and by using that, it is able to measure liquid level and flux too.

### Safety Management

- Be sure to install a protecting device where exist abrupt change of pressure, vibration and pulsation.
- Do not give impact during the transportation, installation and usage.
- Be sure to install pressure gauge to be horizontal and vertical.
  - ※ - Caution: If internal pressure on only one side of accessing port is put, it might get damage.
  - Must use 3-WAY VALVE

### Purpose of Use

- Measure the influx of pipe line using orifice as a differential pressure type flow meter
- Measure sealed tank's liquid level as a differential pressure liquid level meter.
- Application line of potential difference of pressure, etc

### Production Specification

- ▶ Diameter
  - 100, 150mm
- ▶ Accuracy
  - ±1.5% of Full Scale
- ▶ Scale Range
  - 5 ~ 50 kPa, 0 ~ 1 MPa
- ▶ Working Pressure
  - Static pressure : 75% of Full Scale
  - Fluctuating pressure : 60% of Full Scale
- ▶ Working Temperature
  - Ambient : - 20 ~ 65 °C
  - Fluid : - 20 ~ 80 °C
- ▶ Degree of Protection
  - IP65

### Product Specification

<ul style="list-style-type: none"> <li>+ Case                             <ul style="list-style-type: none"> <li>· STS 304</li> </ul> </li> <li>+ Cover                             <ul style="list-style-type: none"> <li>· STS 304</li> </ul> </li> <li>+ Connection                             <ul style="list-style-type: none"> <li>· STS 316</li> <li>· PT ↔ 1/4(Female)</li> </ul> </li> <li>+ Window                             <ul style="list-style-type: none"> <li>· Tempered safety glass,</li> <li>· Laminated safety glass</li> </ul> </li> </ul>	<ul style="list-style-type: none"> <li>+ Pointer                             <ul style="list-style-type: none"> <li>· Aluminum</li> <li>· Black coating</li> </ul> </li> <li>+ Dial                             <ul style="list-style-type: none"> <li>· Aluminum</li> <li>· White coating</li> <li>· Black (MPa), red (bar) gradations and characters</li> </ul> </li> <li>+ Bellows(Element)                             <ul style="list-style-type: none"> <li>· STS304, STS316</li> </ul> </li> </ul>	<ul style="list-style-type: none"> <li>+ Movement                             <ul style="list-style-type: none"> <li>· STS 304</li> </ul> </li> <li>+ Connecting method                             <ul style="list-style-type: none"> <li>· U-Bolt for 2B Pipe</li> </ul> </li> <li>+ Base Pressure                             <ul style="list-style-type: none"> <li>· 5 MPa</li> </ul> </li> <li>+ Option                             <ul style="list-style-type: none"> <li>· 3-Way or 5-Way Manifold Valve</li> <li>· Accessories</li> </ul> </li> </ul>
--	---	--

Pressure Gauge

Differential Pressure Gauge & Switch

Accessories of Pressure Gauge

Thermometer & Thermometer Switch

Thermocouple & RTD

Thermowell

Transmitter

Indicator etc.

Technical data

# Differential Pressure Gauge

Model No. **SS-3302 Series**

## Model No. | SS-3302 (100mm) Bracket For 2B Pipe Type

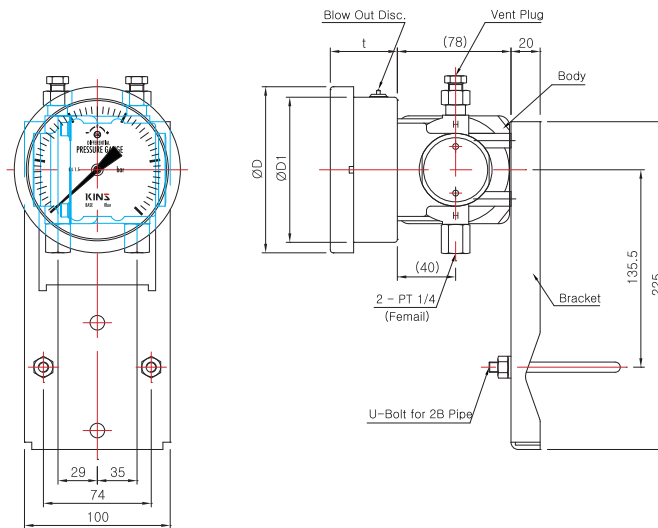

## Model No. | SS-3302 (150mm) Bracket For 2B Pipe Type

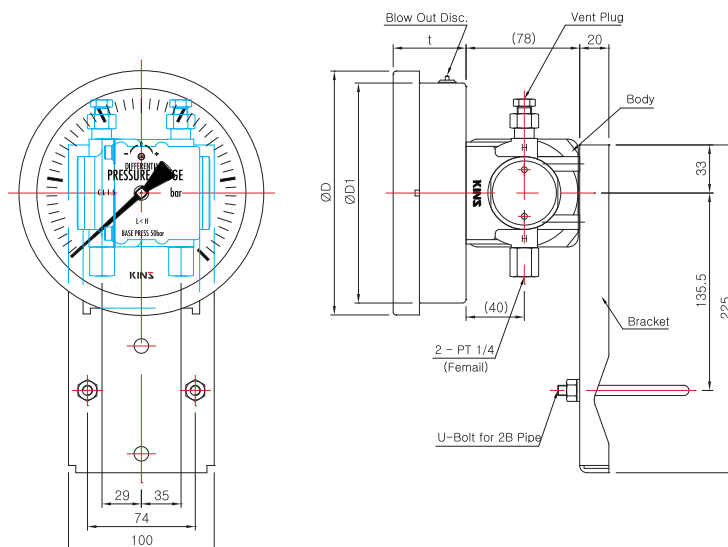

### Dimensions (mm)

Model No.	Con'n (d)	ØD	ØD1	t
SS-3302-100	PT 1/4 (Female)	114	100	(46)
SS-3302-150		168	152	(50)

\*( )The measurement in the blanket is approximate.